

**DF52**

**(A422)**

1. Exterior& Transport Section (A422) . . . . .	2
2. Feed-in Section (A422) . . . . .	4
3. Invert & Exit Section (A422) . . . . .	6
4. DF Main Board (A422) . . . . .	8
5. Indication Board (A422) . . . . .	10
6. DF Main Harness (A422) . . . . .	12
7. Interface Harness (A422) . . . . .	14
8. Decal & Document (A422) . . . . .	16
<b>Parts Index . . . . .</b>	<b>20</b>

# 1. EXTERIOR & TRANSPORT SECTION (A422)

Feb. 28, '89

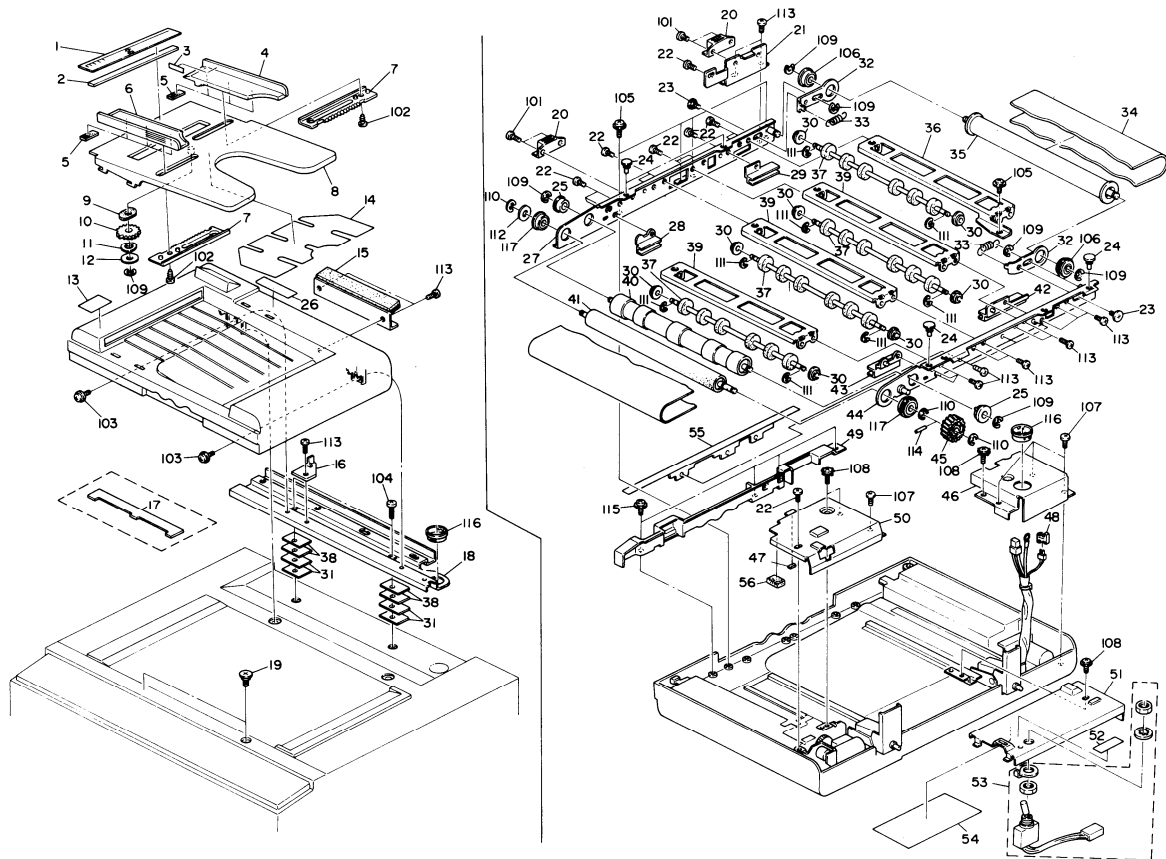



## 2. FEED-IN SECTION (A422)

Feb. 28, '89

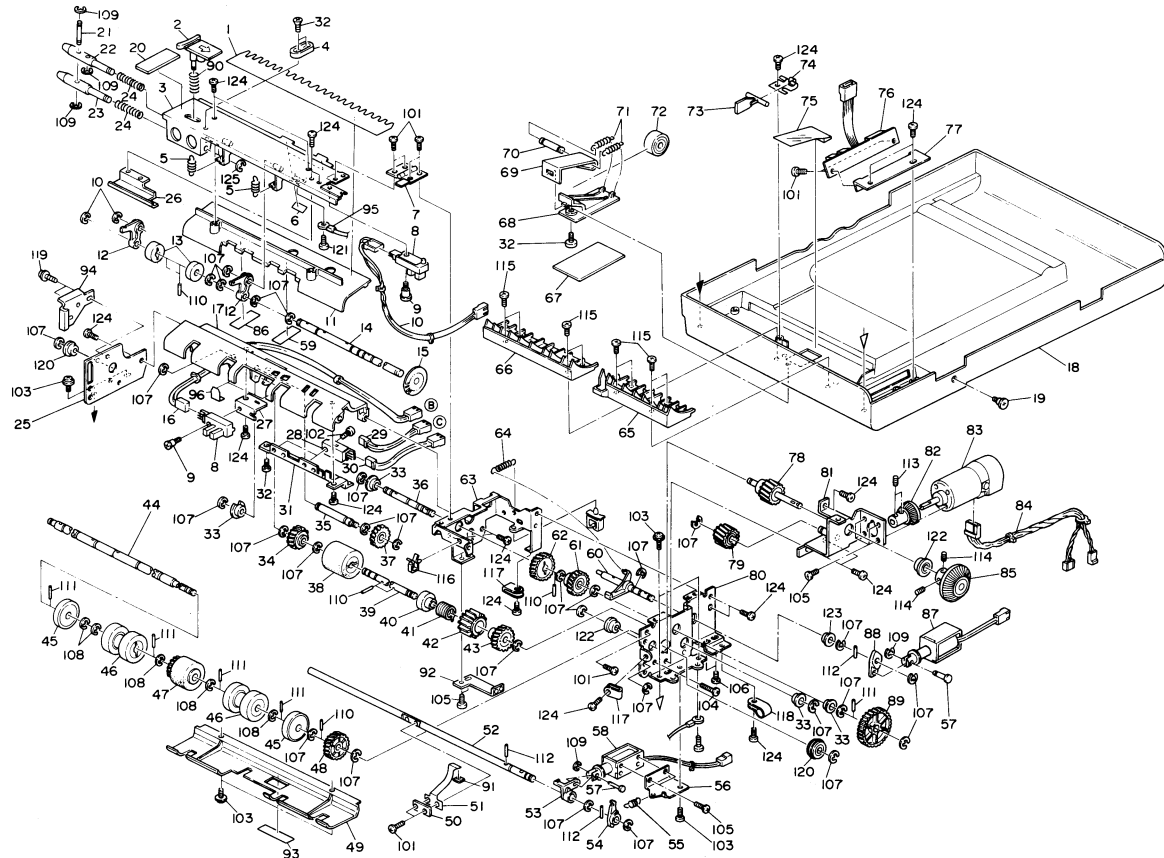

## 2. FEED-IN SECTION (A422)

Feb. 28, '89

Index No.	Part No.	Description	Q'ty Per Assembly
1	A437 1066	Guide Mylar	1
2	A465 1077	Release Lever	1
3	A465 1057	Pull-out Bracket	1
4	A465 1076	Release Lever Knob	1
5	A422 1086	Pull-out Spring	2
6	A422 1063	Seal - 0.7x13x20	2
7	A422 1064	Hinge - Pull-out	1
8	5205 5250	L.E.D Sensor Type - S	2
9	A422 1087	Shoulder Screw - M3x3	2
10	A422 5202	Harness - Pulse Generator	1
11	A437 1065	Lower Guide Plate	1
12	A422 1071	Pull-out Lever	2
13	A422 1068	Relay Roller	2
14	A422 1067	Relay Roller Shaft	1
15	A422 1070	Pulse Generator	1
16	A422 5201	Interface Harness	1
17	A437 1026	Upper Guide Plate	1
18	A422 1301	DF Upper Cover - 115V	1
18	A422 1302	DF Upper Cover - 220/240V	1
19	5219 1957	Stepped Screw - M4	1
20	A465 1068	Cushion - 2.5x14x43	1
21	A465 1075	Shaft - 3x25	1
22	A465 1074	Pin - 4x77.5	1
23	A465 1073	Pin - 4x76.5	1
24	A465 1072	Lock Spring	2
25	A422 1072	Front Side Plate	1
26	A465 1069	Harness Cover	1
27	A422 1047	Set Sensor Bracket	1
28	A422 5270	Photosensor	2
29	A422 5207	Harness - Registration	1
30	A422 5208	Harness - Paper Size	1
31	A422 1093	Sensor Bracket	1
32	5875 2088	Shoulder Screw - M4	4
33	A422 1078	Bushing - 6x12x4mm	4
34	A422 1051	Gear - 23T	1

Index No.	Part No.	Description	Q'ty Per Assembly
35	A422 1044	Idle Shaft	1
36	A422 1503	Idle Shaft	1
37	A422 1042	Idle Gear - 22Z	1
38	A422 1046	Pick-up Roller	1
39	A422 1048	Pick-up Shaft	1
40	A422 1002	Clutch Boss	1
41	5918 2163	Clutch Spring	1
42	5918 2164	Clutch Sleeve	1
43	A422 1001	Gear - 24T	1
44	A422 1023	Feed Roller Shaft	1
45	A422 1045	Pull-out Roller	2
46	A422 1090	Side Roller	2
47	A422 1003	Feed Roller	1
48	A422 1041	Gear - 27T	1
49	A422 1025	Original Guide	1
50	A422 1602	Pick-up Lever Plate	1
51	A422 1600	Pick-up Lever	1
52	A422 1601	Pick-up Shaft	1
53	A422 1032	Lever - Pick-up Solenoid	1
54	A422 1031	Lever - Pick-up Spring	1
55	A422 1082	Pick-up Spring	1
56	A422 1033	Pick-up Solenoid Bracket	1
57	5894 2229	Solenoid Pin	2
58	A422 5255	Solenoid - DC24V	1
59	A465 1067	Mylar - 0.1x14.5x44	1
60	A422 1005	Clutch Pawl - Pick-up Roller	1
61	A422 1049	Gear - 27T	1
62	A422 1050	Gear - 29T	1
63	A422 1021	Side Plate	1
64	5894 2176	Spring - Detent Arm	1
65	A422 1291	Rear Guide Plate	1
66	A422 1290	Front Guide Plate	1
67	A422 1351	Seal - 0.5x37x71mm	1
68	A422 1352	Friction Belt Holder	1
69	A422 1354	Friction Belt	1

Index No.	Part No.	Description	Q'ty Per Assembly
70	A422 1356	Pin - 3x26mm	1
71	A422 1355	Friction Belt Spring	2
72	A422 1069	Friction Roller	1
73	A422 1295	Set Sensor Actuator	1
74	A422 1176	Set Sensor Actuator Bracket	1
75	A422 1390	Entrance Seal	1
76	A422 5260	Indication Board	1
77	A422 1177	Indication Bracket	1
78	A422 1504	Shaft/Gear - 16T	1
79	A422 1506	Gear - 25T	1
80	A422 1510	Rear Side Plate	1
81	A422 1507	Feed-in Motor Bracket	1
82	A422 1501	Gear - 20T	1
83	A422 5300	Feed-in Motor - DC10W	1
84	A422 5204	Feed-in Motor Harness (115V)	1
84	A422 5510	Feed-in Motor Harness (220/240V)	1
85	A422 1502	Gear - 45T	1
86	A465 1066	Mylar - 0.1x21x58	1
87	A422 5252	Solenoid - DC24V	1
88	A422 1040	Feed-in Solenoid Lever	1
89	A422 1505	Gear - 57T	1
90	A465 1070	Lever Spring	1
91	A422 1603	Seal - 2x8x14	1
92	A422 1022	Support Plate	1
93	A422 1396	Mylar - 0.125x14x45.5	1
94	A465 1080	Fixing Plate - Feed-in Unit	1
95	A422 5212	Grounding Wire	1
96	A465 1027	Guide Plate - Paper Feed	2

Index No.	Part No.	Description	Q'ty Per Assembly
101	0313 0060W	Philips Pan Head Screw - M3x6	1
102	0951 3010W	Philips Screw With Flat Washer - M3x10	1
103	0951 4006W	Philips Screw With Flat Washer - M4x6	1
104	0313 0100W	Philips Pan Head Screw - M3x10	1
105	0313 0040W	Philips Pan Head Screw - M3x4	1
106	0951 3004W	Philips Screw With Flat Washer - M3x4	1
107	0720 0040E	Retaining Ring - M4	1
108	0720 0060E	Retaining Ring - M6	1
109	0720 0025E	Retaining Ring - M2.5	1
110	0632 0100G	Pin 2x10mm	1
111	0632 0140G	Parallel Pin	1
112	0632 0080G	Parallel Key - 2x8mm	1
113	0573 0030E	Hexagon Headless Set Screw - M3x3	1
114	0573 0060E	Hexagon Headless Set Screw - M3x6	1
115	0354 0060W	Philips Truss Head Screw - M4x6	1
116	1105 0199	Clamp	1
117	1105 0008	Nylon Clip - 2N	1
118	1105 0009	Nylon Clip - 5N	1
119	0951 4005W	Philips Screw With Flat Washer - M4x5	1
120	0741 3506	Ball Bearing - 6x12x4mm	1
121	0950 4006W	Philips Screw With Lock Washer - M4x6	1
122	0741 3505	Ball Bearing - 5x10x4mm	1
123	0805 3383	Bushing - M5	1
124	0314 0060W	Philips Pan Head Screw - M4x6	1
125	0720 0030E	Retaining Ring - M3	1

### 3. INVERT & EXIT SECTION (A422)

Feb. 28, '89

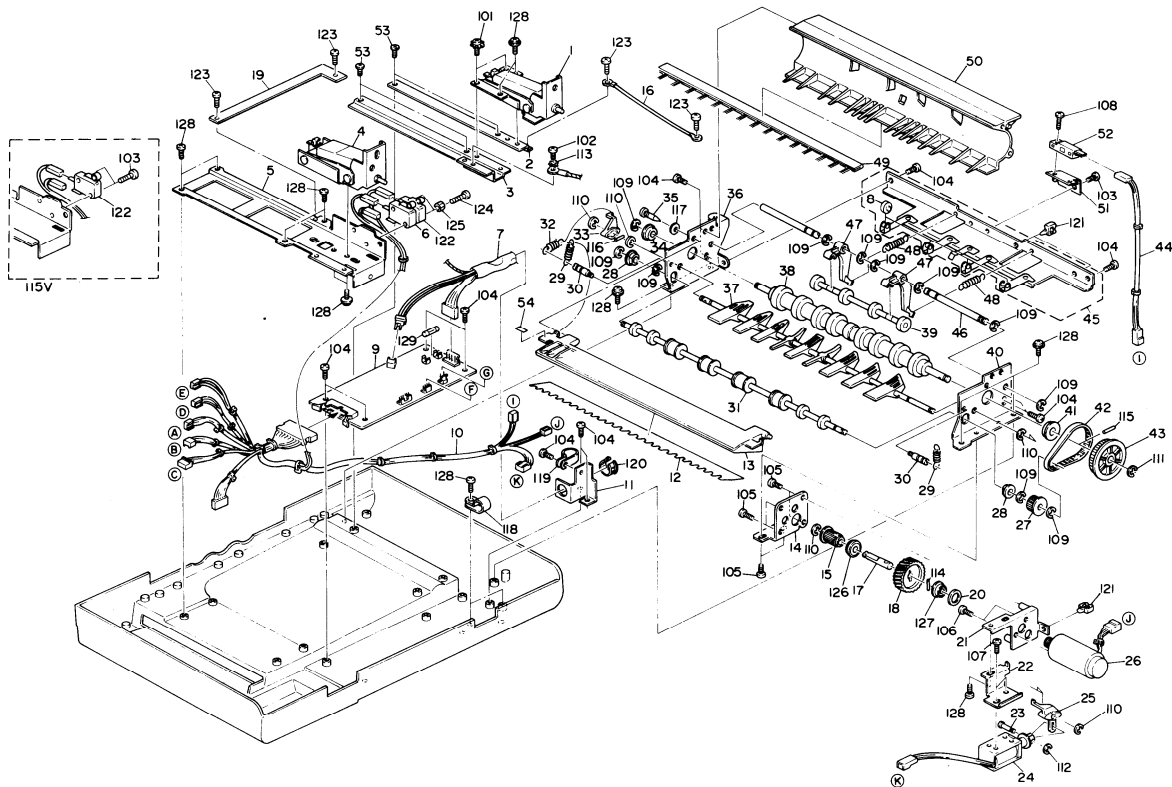

3. INVERT & EXIT SECTION (A422)

Feb. 28, '89

Index No.	Part No.	Description	Q'ty Per Assembly
1	A422 1499	Right Hinge	1
2	A422 1121	Right Bracket - Right Hinge	1
3	A422 1120	Left Bracket - Right Hinge	1
4	A422 1394	Left Hinge	1
5	A422 1119	Left Hinge Bracket	1
6	A422 5550	Lift Switch (220/240V)	1
7	A422 5205	Interface Harness	1
8	A422 1249	Upper Exit Roller	4
9	A422 5170	DF Main Board	1
10	A422 5500	Main Harness	1
11	A422 1175	Harness Bracket	1
12	5918 2623	Paper Guide Mylar	1
13	A422 1225	Inverter Guide Plate	1
14	A422 1260	Front Side Plate	1
15	A409 1192	Pulley - 15T	1
16	A465 5213	Grounding Wire	1
17	A409 1195	Exit Drive Shaft	1
18	A422 1265	Sear - 46T	1
19	A465 1126	Grounding Plate	1
20	A409 1197	Spacer - 10x16x1.6mm	1
21	A422 1261	Rear Side Plate	1
22	A422 1232	Inverter Solenoid Bracket	1
23	5894 2229	Solenoid Pin	1
24	A422 5255	Solenoid - DC24V	1
25	A422 1235	Rear Lever	1
26	A422 5310	Feed-out Motor - DC10W	1
27	A409 1161	Pulley - 21T	1
28	5053 0447	Bushing - M6	2
29	A422 1226	Spring - Inverter Guide Plate	2
30	A409 1150	Spring Anchor	2
31	A422 1240	Upper Exit Roller	1
32	A422 1231	Inverter Gate Spring	1
33	A422 1234	Front Lever	1
34	A422 1078	Bushing - 6x12x4mm	1
35	5446 2824	Screw - Duplex Guide Plate	1

Index No.	Part No.	Description	Q'ty Per Assembly
36	A422 1275	Front Side Plate - Feed-out	1
37	A422 1230	Inverter Pawls	1
38	A422 1210	Inverter Roller	1
39	A422 1216	Inverter Support Roller	1
40	A422 1276	Rear Side Plate - Feed-out	1
41	A422 1079	Bushing - 8x16x5mm	1
42	A422 1270	Timing Belt - 81XL	1
43	A409 1143	Pulley - 50T	1
44	A422 5203	Feed-out Sensor Harness	1
45	A422 1245	Upper Exit Roller Ass'y	1
46	A422 1218	Pressure Lever Shaft	1
47	A422 1217	Pressure Lever	2
48	A422 1219	Pressure Lever Spring	2
49	A422 1257	Antistatic Brush	1
50	A422 1255	Inverter Guide Plate	1
51	A422 1251	Bracket - Exit Sensor	1
52	A422 5270	Photosensor	1
53	5875 2088	Shoulder Screw - M4	4
54	A422 2030	Decal - Inverter Guide Plate	1

Index No.	Part No.	Description	Q'ty Per Assembly
101	0801 1185	Philips Truss Head Screw - M4x8	
102	0314 0060M	Philips Pan Head Screw - M4x6	
103	0313 0140W	Philips Pan Head Screw - M3x14	
104	0314 0060W	Philips Pan Head Screw - M4x6	
105	0951 3006W	Philips Screw With Flat Washer - M3x6	
106	0313 0060W	Philips Pan Head Screw - M3x6	
107	0313 0040W	Philips Pan Head Screw - M3x4	
108	0951 3010W	Philips Screw With Flat Washer - M3x10	
109	0720 0040E	Retaining Ring - M4	
110	0720 0030E	Retaining Ring - M3	
111	0720 0060E	Retaining Ring - M6	
112	0720 0025E	Retaining Ring - M2.5	
113	0704 0040C	Toothed Washer - M4	
114	0632 0100G	Pin 2X10mm	
115	0633 0120G	Parallel Pin - M3x12	
116	0632 0080G	Parallel Key - 2x8mm	
117	0701 0040B	Flat Washer - M4	
118	1105 0009	Nylon Clip - 5N	
119	1105 0011	Nylon Clip - 8N	
120	1106 0430	Bushing - 13mm	
121	1105 0199	Clamp	
122	1204 1319	Micro Switch (115V)	
122	1204 2136	Micro Switch (220/240V)	
123	0950 4006W	Philips Screw With Lock Washer - M4x6	
124	0313 0300W	Philips Pan Head Screw - M3x30	
125	0710 0030W	Hexagon Nut - M3	
126	0742 3905	Ball Bearing - 5x13x4mm	
127	0741 3505	Ball Bearing - 5x10x4mm	
128	0951 4006W	Philips Screw With Flat Washer - M4x6	
129	1107 0413	Fuse - 3A 125V	

Index No.	Part No.	Description	Q'ty Per Assembly
-----------	----------	-------------	-------------------



CONNECTOR		CAPACITOR		DIP SW		FUSE		TEST PIN		POTENTIOMETER											
SYMBOL NO.	INDEX NO.	SYMBOL NO.	INDEX NO.	SYMBOL NO.	INDEX NO.	SYMBOL NO.	INDEX NO.	SYMBOL NO.	INDEX NO.	SYMBOL NO.	INDEX NO.										
CM101	105	C101	140	C111	151	C121	155	C131	155	C141	155	C151	155	DTPI01	113	F0101	112	TP101	102	VR101	137
CM102	103	C102	148	C112	151	C122	155	C132	155	C142	149	C152	154					TP102	102	VR102	136
CM103	106	C103	145	C113	143	C123	155	C133	155	C143	155	C153	155					TP103	102	VR103	136
CM104	104	C104	147	C114	153	C124	155	C134	155	C144	149	C154	155					TP104	102	VR106	138
CM105	107	C105	146	C115	153	C125	155	C135	155	C145	155	C155	152					TP105	102		
CM106	2	C106	142	C116	141	C126	155	C136	166	C146	155	C156	155					TP106	102		
		C107	150	C117	142	C127	155	C137	155	C147	155	C157	155					TP107	102		
		C108	147	C118	155	C128	155	C138	155	C148	155	C158	155								
		C109	144	C119	155	C129	155	C139	155	C149	155	C159	155								
		C110	145	C120	155	C130	155	C140	155	C150	155										

IC		JP		JSM		LED		NP		TRANSISTOR		RESISTOR					
SYMBOL NO.	INDEX NO.	SYMBOL NO.	INDEX NO.	SYMBOL NO.	INDEX NO.	SYMBOL NO.	INDEX NO.	SYMBOL NO.	INDEX NO.	SYMBOL NO.	INDEX NO.	SYMBOL NO.	INDEX NO.				
IC101	101	IC108	129	JP102	109	JSM1	108	LED101	118	NP101	139	Q101	115	R101	133	R111	132
	126	IC109	123	JP103	109	JSM2	108	LED102	118					R102	131	R112	132
IC102	4	IC110	121			JSM3	108	LED103	118					R103	169	R113	132
	116	IC111	129			JSM4	108	LED104	118					R104	169	R114	170
IC103	3	IC112	124					LED105	118					R105	167	R115	172
IC104	127	IC113	125					LED106	118					R106	132	R116	158
IC105	122	IC114	129					LED107	118					R107	167	R117	161
IC106	1	IC115	128											R108	171	R118	164
	110	IC116	119											R109	134	R119	161
IC107	120													R110	134	R120	159

OSCILLATOR		RESISTOR ARRAY		SWITCH	
SYMBOL NO.	INDEX NO.	SYMBOL NO.	INDEX NO.	SYMBOL NO.	INDEX NO.
OSC101	130	RAY101	135		

SYMBOL NO.	INDEX NO.	SYMBOL NO.	INDEX NO.	SYMBOL NO.	INDEX NO.	SYMBOL NO.	INDEX NO.	SYMBOL NO.	INDEX NO.	SYMBOL NO.	INDEX NO.						
R121	164	R131	161	R141	161	R151	161	R161	161	R171	161	R181	161	R191	158	SW101	114
R122	156	R132	160	R142	161	R152	161	R162	161	R172	161	R182	158	R192	165	SW102	114
R123	161	R133	164	R143	162	R153	161	R163	161	R173	161	R183	158	R193	165		
R124	161	R134	164	R144	165	R154	161	R164	161	R174	161	R184	158	R194	165		
R125	158	R135	164	R145	161	R155	161	R165	161	R175	161	R185	158	R195	165		
R126	159	R136	162	R146	161	R156	161	R166	161	R176	168	R186	158	R196	163		
R127	159	R137	164	R147	161	R157	159	R167	161	R177	158	R187	161				
R128	159	R138	161	R148	161	R158	159	R168	161	R178	158	R188	158				
R129	158	R139	157	R149	161	R159	162	R169	161	R179	158	R189	158				
R130	160	R140	161	R150	161	R160	162	R170	158	R180	161	R190	161				



## LED

SYMBOL NO.	INDEX NO.
LED200	105
LED201	105
LED202	106

## CONNECTOR

SYMBOL NO.	INDEX NO.
CN200	101
	103
CN201	102
	104

## 5. INDICATION BOARD (A422)

Feb. 28, '89

Index No.	Part No.	Description	Q'ty Per Assembly
*	A422 5260	Indication Board	1

Index No.	Part No.	Description	Q'ty Per Assembly
101	1100 1306	Terminal	
102	1100 1328	Contact	
103	1102 1807	Insulating Sleeve	
104	1102 1967	Connector - 6P	
105	1403 0236	L.E.D. - MU02 - 520	
106	1403 0328	L.E.D. - PV5551K	

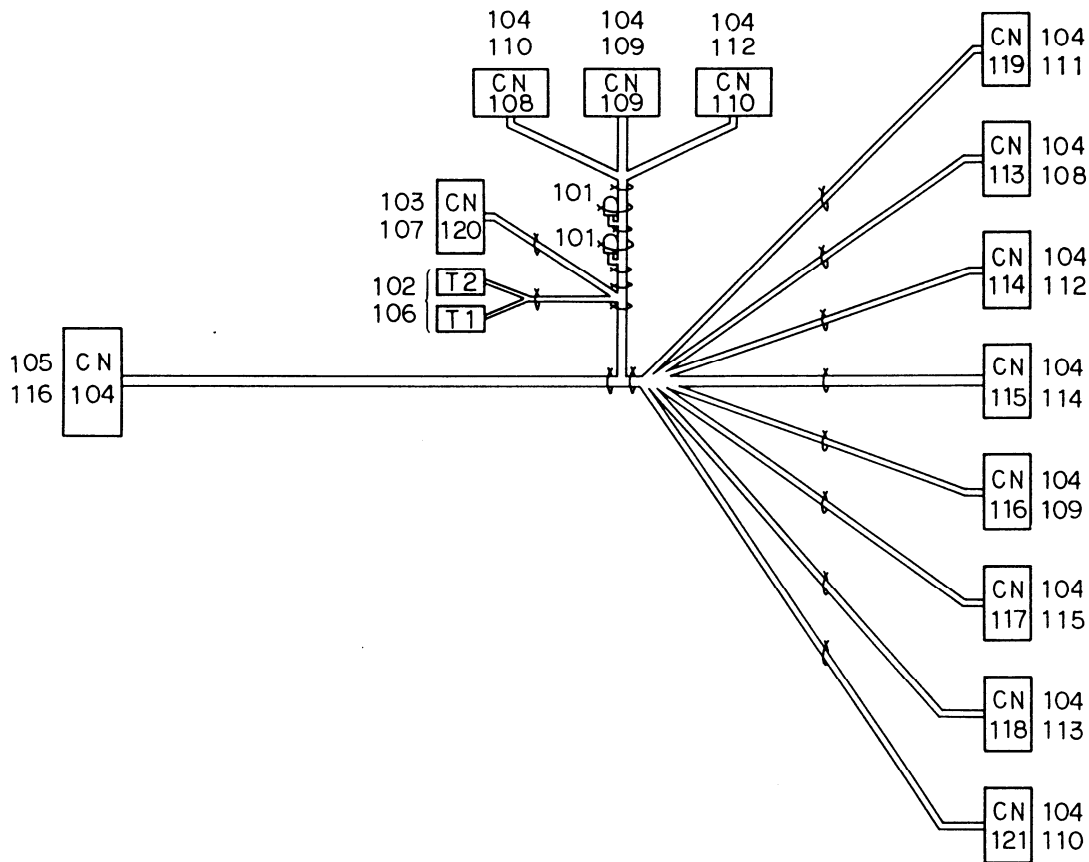

## 6. DF MAIN HARNESS (A422)

Feb. 28, '89

Index No.	Part No.	Description	Q'ty Per Assembly
*	A422 5200	Main Harness - 115V	1
*	A422 5500	Main Harness - 220/240V	1

Index No.	Part No.	Description	Q'ty Per Assembly
101	1100 0340	Closed Terminal	
102	1100 1169	Fastening Receptacle (115V)	
102	1100 1172	Fastening Receptacle (220/240V)	
103	1100 1253	Pin - Mate-N-Lock	
104	1100 1327	Contact	
105	1100 1348	Pin Contact	
106	1102 1408	Connector - 1P (115V)	
106	1102 1404	Receptacle Housing (220/240V)	
107	1102 1756	Connector - 2P	
108	1102 1910	Connector - 2P	
109	1102 1911	Connector - 3P	
110	1102 1912	Connector - 4P	
111	1102 1914	Connector - 6P	
112	1102 1924	Connector - 2P	
113	1102 1925	Connector - 3P	
114	1102 1938	Connector - 2P	
115	1102 1939	Connector - 3P	
116	1103 0659	Connector - 34P	

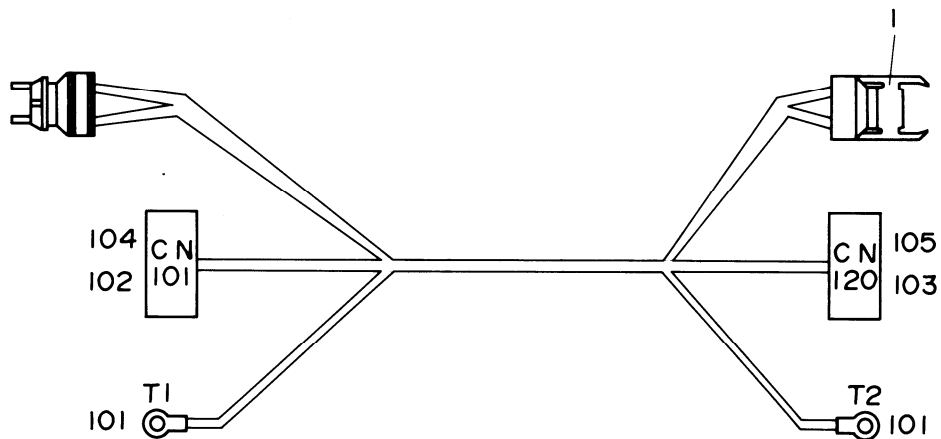

## 7. INTERFACE HARNESS (A422)

Feb. 28, '89

Index No.	Part No.	Description	Qty Per Assembly
*	A422 5205	Interface Harness	1
1	A422 5211	Fiber Connector	1

Index No.	Part No.	Description	Qty Per Assembly
101	1100 0051	Wire Terminal	
102	1100 1190	Socket - Mate-N-Lock	
103	1100 1447	Socket - Mate-N-Lock	
104	1102 1374	Connector - 5265-4P	
105	1102 1517	Connector - 4P	



1



2

<p><b>1) Einrichten des Originals</b></p> <p>1) Das Original wird oben in den Scanner eingelegt.</p> <p>2) Das Original wird an der linken und rechten Seite des Scanners ausgerichtet.</p> <p>3) Überprüfen Sie, ob zwischen dem Original und dem Scanner keine Lücken vorhanden sind.</p> <p>4) Das Original ist im Scanner und wird von unten durch den Scanner transportiert.</p>	<p><b>2) Original einlegen</b></p> <p>1) Das Original wird oben in den Scanner eingelegt.</p> <p>2) Das Original wird an der linken und rechten Seite des Scanners ausgerichtet.</p> <p>3) Überprüfen Sie, ob zwischen dem Original und dem Scanner keine Lücken vorhanden sind.</p> <p>4) Das Original ist im Scanner und wird von unten durch den Scanner transportiert.</p>	<p><b>3) Scanner einrichten</b></p> <p>1) Die Rollen des Scanners werden so eingestellt, dass sie das Original richtig transportieren können.</p> <p>2) Überprüfen Sie, ob die Rollen des Scanners richtig eingestellt sind.</p> <p>3) Überprüfen Sie, ob die Rollen des Scanners richtig eingestellt sind.</p> <p>4) Überprüfen Sie, ob die Rollen des Scanners richtig eingestellt sind.</p>	<p><b>4) Original einlegen</b></p> <p>1) Das Original wird oben in den Scanner eingelegt.</p> <p>2) Das Original wird an der linken und rechten Seite des Scanners ausgerichtet.</p> <p>3) Überprüfen Sie, ob zwischen dem Original und dem Scanner keine Lücken vorhanden sind.</p> <p>4) Das Original ist im Scanner und wird von unten durch den Scanner transportiert.</p>	<p><b>5) Original einlegen</b></p> <p>1) Das Original wird oben in den Scanner eingelegt.</p> <p>2) Das Original wird an der linken und rechten Seite des Scanners ausgerichtet.</p> <p>3) Überprüfen Sie, ob zwischen dem Original und dem Scanner keine Lücken vorhanden sind.</p> <p>4) Das Original ist im Scanner und wird von unten durch den Scanner transportiert.</p>	<p><b>6) Original einlegen</b></p> <p>1) Das Original wird oben in den Scanner eingelegt.</p> <p>2) Das Original wird an der linken und rechten Seite des Scanners ausgerichtet.</p> <p>3) Überprüfen Sie, ob zwischen dem Original und dem Scanner keine Lücken vorhanden sind.</p> <p>4) Das Original ist im Scanner und wird von unten durch den Scanner transportiert.</p>
---	--	--	--	--	--

3

DIP SW 101				FUNCTION
1	2	3	4	Normal Mode
1	0	0	0	1 Slided Free Run
0	1	0	1	2 Slided Free Run
0	0	1	1	32x Test (OFF: SW 101 ON, OFF: SW 102 ON)
1	1	0	1	Motor Test (M1: VR101, M2: VR106)
1	1	1	1	All Indicators On

4



5

Place originals face up after correcting the curl.

7



8

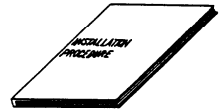

6

Face Up

Labels: 8V, 8, 8V, 10, 11

Labels: 8, F, 8, A3, A4

## 8. DECAL &amp; DOCUMENT (A422)

Feb. 28, '89

Index No.	Part No.	Description	Q'ty Per Assembly
1	5936 7901	Decal - English	1
2	A422 2021	Decal - Misfeed Removal	1
2	A422 2031	Decal - Misfeed - Multi-Language	1
3	A465 2017	Decal - DIP Switch	1
4	A465 2025	Original Limit Decal	1
5	A465 2031	Decal - Set	1
6	A465 1337	Decal -Original Table - LT	1
6	A465 1338	Decal - Original Table - A4	1
7	A422 2030	Decal - Inverter Guide Plate	1
8	A422 8610	Installation Procedure - English	1
8	A422 8615	Installation Procedure - 5 Languages	1

Index No.	Part No.	Description	Q'ty Per Assembly

# **PARTS INDEX**

Parts No.	Description	Page and Index No.
A422 1001	Gear - 24T	5-43
A422 1002	Clutch Boss	5-40
A422 1003	Feed Roller	5-47
A422 1005	Clutch Pawl - Pick-up Roller	5-60
A422 1021	Side Plate	5-63
A422 1022	Support Plate	5-92
A422 1023	Feed Roller Shaft	5-44
A422 1025	Original Guide	5-49
A422 1031	Lever - Pick-up Spring	5-54
A422 1032	Lever - Pick-up Solenoid	5-53
A422 1033	Pick-up Solenoid Bracket	5-56
A422 1040	Feed-in Solenoid Lever	5-88
A422 1041	Gear - 27T	5-48
A422 1042	Idle Gear - 22Z	5-37
A422 1044	Idle Shaft	5-35
A422 1045	Pull-out Roller	5-45
A422 1046	Pick-up Roller	5-38
A422 1047	Set Sensor Bracket	5-27
A422 1048	Pick-up Shaft	5-39
A422 1049	Gear - 27T	5-61
A422 1050	Gear - 29T	5-62
A422 1051	Gear - 23T	5-34
A422 1056	Gear - 19T	3-45
A422 1063	Seal - 0.7x13x20	5-6
A422 1064	Hinge - Pull-out	5-7
A422 1067	Relay Roller Shaft	5-14
A422 1068	Relay Roller	5-13
A422 1069	Friction Roller	5-72
A422 1070	Pulse Generator	5-15
A422 1071	Pull-out Lever	5-12
A422 1072	Front Side Plate	5-25
A422 1078	Bushing - 6x12x4mm	3-25
A422 1078	Bushing - 6x12x4mm	5-33
A422 1078	Bushing - 6x12x4mm	7-34
A422 1079	Bushing - 8x16x5mm	7-41

Parts No	Description	Page and Index No.
A422 1082	Pick-up Spring	5-55
A422 1086	Pull-out Spring	5-5
A422 1087	Shoulder Screw - M3x3	5-9
A422 1090	Side Roller	5-46
A422 1093	Sensor Bracket	5-31
A422 1103	Rear Frame	3-44
A422 1106	Stay	3-36
A422 1107	Stay - Belt Support Roller	3-39
A422 1108	Stopper	3-24
A422 1112	Belt Tension Spring	3-33
A422 1114	Driven Roller - Transport Belt	3-35
A422 1116	Belt Pressure Roller	3-40
A422 1119	Left Hinge Bracket	7-5
A422 1120	Left Bracket - Right Hinge	7-3
A422 1121	Right Bracket - Right Hinge	7-2
A422 1127	Transport Belt	3-34
A422 1130	Reflector Plate	3-55
A422 1135	Magnet Catch Bracket	3-21
A422 1175	Harness Bracket	7-11
A422 1176	Set Sensor Actuator Bracket	5-74
A422 1177	Indication Bracket	5-77
A422 1183	Main Board Cover	3-51
A422 1184	Feed-out Motor Cover	3-46
A422 1185	Belt Guide - Front Left	3-28
A422 1186	Belt Guide - Rear Left	3-43
A422 1187	Belt Guide - Front Right	3-29
A422 1188	Belt Guide - Rear Right	3-42
A422 1191	Mounting Bracket	3-18
A422 1210	Inverter Roller	7-38
A422 1216	Inverter Support Roller	7-39
A422 1217	Pressure Lever	7-47
A422 1218	Pressure Lever Shaft	7-46
A422 1219	Pressure Lever Spring	7-48
A422 1225	Inverter Guide Plate	7-13
A422 1226	Spring - Inverter Guide Plate	7-29

Parts No.	Description	Page and Index No.
A422 1230	Inverter Pawls	7-37
A422 1231	Inverter Gate Spring	7-32
A422 1232	Inverter Solenoid Bracket	7-22
A422 1234	Front Lever	7-33
A422 1235	Rear Lever	7-25
A422 1240	Upper Exit Roller	7-31
A422 1245	Upper Exit Roller Ass'y	7-45
A422 1249	Upper Exit Roller	7-8
A422 1251	Bracket - Exit Sensor	7-51
A422 1255	Inverter Guide Plate	7-50
A422 1257	Antistatic Brush	7-49
A422 1260	Front Side Plate	7-14
A422 1261	Rear Side Plate	7-21
A422 1265	Gear - 46T	7-18
A422 1270	Timing Belt - 81XL	7-42
A422 1275	Front Side Plate - Feed-out	7-36
A422 1276	Rear Side Plate - Feed-out	7-40
A422 1290	Front Guide Plate	5-66
A422 1291	Rear Guide Plate	5-65
A422 1295	Set Sensor Actuator	5-73
A422 1301	DF Upper Cover - 115V	5-18
A422 1302	DF Upper Cover - 220/240V	5-18
A422 1320	Original Table	3-8
A422 1335	Magnet - Original Table	3-2
A422 1351	Seal - 0.5x37x71mm	5-67
A422 1352	Friction Belt Holder	5-68
A422 1354	Friction Belt	5-69
A422 1355	Friction Belt Spring	5-71
A422 1356	Pin - 3x26mm	5-70
A422 1361	Pack - Side Guide	3-7
A422 1366	Front Side Guide	3-6
A422 1376	Rear Side Guide	3-4
A422 1380	Shoulder Screw - M4x12	3-19
A422 1385	Original Exit Guide	3-14
A422 1389	Spacer 0.2mm	3-38

Parts No.	Description	Page and Index No.
A422 1390	Entrance Seal	5-75
A422 1394	Left Hinge	7-4
A422 1395	Shaft	3-17
A422 1396	Mylar - 0.125x14x45.5	5-93
A422 1397	Spacer - 0.5mm	3-31
A422 1499	Right Hinge	7-1
A422 1500	Belt Drive Motor Cover	3-50
A422 1501	Gear - 20T	5-82
A422 1502	Gear - 45T	5-85
A422 1503	Idle Shaft	5-36
A422 1504	Shaft/Gear - 16T	5-78
A422 1505	Gear - 57T	5-89
A422 1506	Gear - 25T	5-79
A422 1507	Feed-in Motor Bracket	5-81
A422 1510	Rear Side Plate	5-80
A422 1600	Pick-up Lever	5-51
A422 1601	Pick-up Shaft	5-52
A422 1602	Pick-up Lever Plate	5-50
A422 1603	Seal - 2x8x14	3-47
A422 1603	Seal - 2x8x14	5-91
A422 1604	Cushion - 8x15x25	3-56
A422 2021	Decal - Misfeed Removal	17-2
A422 2021	Decal - Misfeed Removal	3-13
A422 2030	Decal - Inverter Guide Plate	17-7
A422 2030	Decal - Inverter Guide Plate	7-54
A422 2031	Decal - Misfeed - Multi-Language	17-2
A422 2031	Decal - Misfeed - Multi-Language	3-13
A422 5170	DF Main Board	7-9
A422 5170	DF Main Board	9-*
A422 5190	IC - MBM27C128-30	9-1
A422 5200	Main Harness - 115V	13-*
A422 5201	Interface Harness	5-16
A422 5202	Harness - Pulse Generator	5-10
A422 5203	Feed-out Sensor Harness	7-44
A422 5204	Feed-in Motor Harness (115V)	5-84

Parts No.	Description	Page and Index No.
A422 5205	Interface Harness	1 5.*
A422 5205	Interface Harness	7-7
A422 5207	Harness - Registration	5-29
A422 5208	Harness - Paper Size	5-30
A422 5210	Fiber Connector - 2P	9-2
A422 5211	Fiber Connector	15-1
A422 5211	Fiber Connector	3-48
A422 5212	Grounding Wire	5-95
A422 5252	Solenoid - DC24V	5-87
A422 5255	Solenoid - DC24V	5-58
A422 5255	Solenoid - DC24V	7-24
A422 5260	Indication Board	11.*
A422 5260	Indication Board	5-76
A422 5270	Photosensor	5-28
A422 5270	Photosensor	7-52
A422 5300	Feed-in Motor - DC10W	5-83
A422 5310	Feed-out Motor - DC10W	7-26
A422 5350	IC - HCTL-3	9-3
A422 5500	Main Harness - 220/240V	1 3.*
A422 5500	[sin Harness	7-10
A422 5510	Feed-in Motor Harness (220/240V)	5-84
A422 5550	Lift Switch (220/240V)	7-6
A422 8610	Installation Procedure - English	17-8
A422 8615	Installation Procedure - 5 Languages	17-8

Parts No.	Description	Page and Index No.
AA14 3005	Stepped Screw - M4x2.5	3-23
A409 1143	Pulley - 50T	7-43
A409 1150	Spring Anchor	7-30
A409 1161	Pulley - 21T	7-27
A409 1192	Pulley - 15T	7-15
A409 1195	Exit Drive Shaft	7-17
A409 1197	Spacer - 10x16x1.6mm	7-20
A437 1026	Upper Guide Plate	5-17
A437 1065	Lower Guide Plate	5-11
A437 1066	Guide Mylar	5-1
A437 1115	Drive Roller - Transport Belt	3-41
A437 1120	Bracket - Belt Tension Spring	3-32
A437 1125	Angle Stopper	3-15
A437 1179	Lift Switch Actuator	3-16
A465 1027	Guide Plate - Paper Feed	5-96
A465 1057	Pull-out Bracket	5-3
A465 1066	Mylar - 0.1x21x58	5-86
A465 1067	Mylar - 0.1x14.5x44	5-59
A465 1068	Cushion - 2.5x14x43	5-20
A465 1069	Harness Cover	5-26
A465 1070	Lever Spring	5-90
A465 1072	Lock Spring	5-24
A465 1073	Pin - 4x76.5	5-23
A465 1074	Pin - 4x77.5	5-22
A465 1075	Shaft - 3x25	5-21
A465 1076	Release Lever Knob	5-4
A465 1077	Release Lever	5-2
A465 1080	Fixing Plate - Feed-in Unit	5-94
A465 1100	Front Frame	3-27
A465 1118	Belt Support Roller	3-37
A465 1126	Grounding Plate	7-19
A465 1331	Grip Cover	3-49
A465 1337	Decal - Original Table - LT	17-6
A465 1337	Decal - Original Table - LT	3-1
A465 1338	Decal - Original Table - A4	17-6

Parts No.	Description	Page and Index No.
A465 1338	Decal - Original Table - A4	3-1
A465 2017	Decal - DIP Switch	17-3
A465 2017	Decal - DIP Switch	3-54
A465 2025	Original Limit Decal	17-4
A465 2025	Original Limit Decal	3-3
A465 2031	Decal - Set	17-5
A465 2031	Decal - Set	3-26
A465 5213	Grounding Wire	7-16
5053 0447	Bushing - M6	7-28
5205 5250	L.E.D Sensor Type - S	5-8
5219 1957	Stepped Screw - M4	5-19
5443 2657	Gear - 28Z	3-10
5443 2660	Spacer - 6x22x0.5mm	3-12
5443 2712	Cork Pad	3-9
5443 2713	Wave Washer	3-11
5446 2824	Screw - Duplex Guide Plate	7-35
5447 3655	Bushing - 4mm	3-30
5875 2088	Shoulder Screw - M4	3-22
5875 2088	Shoulder Screw - M4	5-32
5875 2088	Shoulder Screw - M4	7-53
5894 2176	Spring - Detent Arm	5-64
5894 2229	Solenoid Pin	5-57
5894 2229	Solenoid Pin	7-23
5894 2747	Mylar - Original Guides	3-5
5918 2163	Clutch Spring	5-41
5918 2164	Clutch Sleeve	5-42
5918 2623	Paper Guide Mylar	7-12
5936 2480	Magnet Catch Ass'y	3-20
5936 5221	Heat Sink	9-4
5936 5348	Thin Original Feed Switch	3-53
5936 7901	Decal - English	17-1
5936 7901	Decal - English	3-52

Parts No.	Description	Page and Index No.
0313 0040W	Philips Pan Head Screw - M3x4	5-105
0313 0040W	Philips Pan Head Screw - M3x4	7-107
0313 0060W	Philips Pan Head Screw - M3x6	5-101
0313 0060W	Philips Pan Head Screw - M3x6	7-106
0313 0100W	Philips Pan Head Screw - M3x10	5-104
0313 0140W	Philips Pan Head Screw - M3x14	7-103
0313 0300W	Philips Pan Head Screw - M3x30	7-124
0314 0060M	Philips Pan Head Screw - M4x6	7-102
0314 0060W	Philips Pan Head Screw - M4x6	3-113
0314 0060W	Philips Pan Head Screw - M4x6	5-124
0314 0060W	Philips Pan Head Screw - M4x6	7-104
0315 0010W	Philips Pan Head Screw - M5x10	3-104
0344 0060D	Philips Truss Head Screw - M4x6	3-115
0344 0060W	Philips Truss Head Screw - M4x6	3-107
0353 0050W	Tapping Screw - M3x5	3-101
0354 0060W	Philips Truss Head Screw - M4x6	5-115
0413 0082W	Tapping Screw - M3x8	3-102
0573 0030E	Hexagon Headless Set Screw - M3x3	5-113
0573 0060E	Hexagon Headless Set Screw - M3x6	5-114
0632 0080G	Parallel Key - 2x8mm	<b>5-112</b>
<b>0632 0080G</b>	Parallel Key - 2x8mm	7-116
0632 0100G	Pin 2x10mm	3-114
0632 0100G	Pin 2X10mm	5-110
0632 0100G	Pin 2x10mm	7-114
0632 0140G	Parallel Pin	5-111
0633 0120G	Parallel Pin - M3x12	7-115
0701 0040B	Flat Washer - M4	7-117
0701 0060B	Flat Washer - M6	3-112
0704 0040C	Toothed Washer - M4	7-113
0710 0030W	Hexagon Nut - M3	7-125
0720 0025E	Retaining Ring - M2.5	5-109
0720 0025E	Retaining Ring - M2.5	7-112
0720 0030E	Retaining Ring - M3	3-111
0720 0030E	Retaining Ring - M3	5-125
0720 0030E	Retaining Ring - M3	7-110

Parts No.	Description	Page and Index No.
0720 0040E	Retaining Ring - M4	3-109
0720 0040E	Retaining Ring - M4	5-107
0720 0040E	Retaining Ring - M4	7-109
0720 0050E	Retaining Ring - M5	3-110
0720 0060E	Retaining Ring - M6	5-108
0720 0060E	Retaining Ring - M6	7-111
0741 3505	Ball Bearing - 5x10x4mm	5-122
0741 3505	Ball Bearing - 5x10x4mm	7-127
0741 3506	Ball Bearing - 6x12x4mm	5-120
0741 3806	Ball Bearing - 6x13x5mm	3-106
0742 3905	Ball Bearing - 5x13x4mm	7-126
0742 3906	Ball Bearing - 6mm	3-117
0801 1185	Philips Truss Head Screw - M4x8	3-108
0801 1185	Philips Truss Head Screw - M4x8	7-101
0805 3383	Bushing - M5	5-123
0950 4006W	Philips Screw With Lock Washer - M4x6	5-121
0950 4006W	Philips Screw With Lock Washer - M4x6	7-123
0951 3004W	Philips Screw With Flat Washer - M3x4	5-106
0951 3006W	Philips Screw With Flat Washer - M3x6	7-105
0951 3010W	Philips Screw With Flat Washer - M3x10	5-102
0951 3010W	Philips Screw With Flat Washer - M3x10	7-108
0951 4005W	Philips Screw With Flat Washer - M4x5	3-103
0951 4005W	Philips Screw With Flat Washer - M4x5	5-119
0951 4006W	Philips Screw With Flat Washer - M4x6	3-105
0951 4006W	Philips Screw With Flat Washer - M4x6	5-103
0951 4006W	Philips Screw With Flat Washer - M4x6	7-128
1005 0843	Heat Sink - OSH2425SP	9-101
1100 0051	Wire Terminal	15-101
1100 0340	Closed Terminal	13-101
1100 1169	Fastening Receptacle (115V)	13-102
1100 1172	Fastening Receptacle (220/240V)	13-102
1100 1190	Socket - Mate-N-Lock	15-102
1100 1253	Pin - Mate-N-Lock	13-103
1100 1306	Terminal	11-101
1100 1327	Contact	13-104

Parts No.	Description	Page and Index No.
1100 1328	Con tact	11-102
1100 1348	Pin Contact	13-105
1100 1447	Socket - Mate-N-Lock	15-103
1101 0328	Connector Pin Contact	9-102
1102 0958	Connector - 2P	9-103
1102 1374	Connector - 5265-4P	15-104
1102 1404	Receptacle Housing (220/240V)	13-106
1102 1408	Connector - 1P (115V)	13-106
1102 1517	Connector - 4P	15-105
1102 1756	Connector - 2P	13-107
1102 1807	Insulating Sleeve	11-103
1102 1910	Connector - 2P	13-108
1102 1911	Connector - 3P	13-109
1102 1912	Connector - 4P	13-110
1102 1914	Connector - 6P	13-111
1102 1924	Connector - 2P	13-112
1102 1925	Connector - 3P	13-113
1102 1938	Connector - 2P	13-114
1102 1939	Connector - 3P	13-115
1102 1967	Connector - 6P	11-104
1102 2966	Connector - HIF3BA-34PA	9-104
1103 0659	Connector - 34P	13-116
1103 0881	Connector - 4P	9-105
1103 1726	Connector - 4P	9-106
1103 1729	Connector - 7P	9-107
1103 1878	Connector - 2P	9-108
1103 3029	Connector - 2P	9-109
1104 0271	LSI Socket - 28P	9-110
1104 0333	Fuse Holder	9-111
1105 0008	Nylon Clip - 2N	5-117
1105 0009	Nylon Clip - 5N	5-118
1105 0009	Nylon Clip - 5N	7-118
1105 0011	Nylon Clip - 8N	7-119
1105 0199	Clamp	5-116
1105 0199	Clamp	7-121



Parts No.	Description	Page and Index No.
1106 0279	Bushing	3-116
1106 0430	Bushing - 13mm	7-120
1107 0413	Fuse - 3A 125V	7-129
1107 0413	Fuse - 3A 125V	9-112
1204 0883	DIP Switch	9-113
1204 1319	Micro Switch (115V)	7-122
1204 1385	Push Switch	9-114
1204 2136	Micro Switch (220/240V)	7-122
1401 0282	Transistor - 2SB1020	9-115
1401 0329	IC - MP4503	9-116
1401 0832	Diode - D S A 1 A 1	9-117
1403 0236	L.E.D. - MU02 - 520	11-105
1403 0308	LED - TLR-102A	9-118
1403 0328	L.E.D. - PY5551K	11-106
1403 0388	Photocoupler - ON3111	9-119
1407 0602	C-MOS,IC TC4040BP	9-120
1407 0604	IC - TC40498P	9-121
1407 1026	IC - SN74LS373N	9-122
1407 1334	IC - UPD7810G	9-123
1407 1348	IC - TD62304AP	9-124
1407 1535	IC - TD62308AP	9-125
1408 0076	IC - $\mu$ PC14132H	9-126
1408 0408	IC - PST518A	9-127
1408 0521	IC - M51971L	9-128
1408 0578	IC - HA17339	9-129
1503 0070	Ceramic Oscillator - 10MHz	9-130
1600 0239	Resistor - 0.47 1W	9-131
1600 0544	Resistor - 1KOHM 1W $\pm$ 1%	9-132
1600 0576	Resistor - 330HM 5W	9-133
1601 1732	Resistor - 390OHM 1W $\pm$ 5%	9-134
1601 7326	Resistor Array - 10KOHM	9-135
1601 8145	Variable Resistor - 5KOHM	9-136
1601 8147	Variable Resistor - 10KOHM 0.5W	9-137
1601 8148	Variable Resistor - 20KOHM	9-138
1602 0953	Coil - 800 $\mu$ H 2.5A	9-139

Parts No.	Description	Page and Index No.
1604 1358	Capacitor - 1000MF 10V	9-140
1604 1378	Capacitor - 1MF 50V	9-141
1604 1379	Capacitor - 2.2 $\mu$ F 50V	9-142
1604 1380	Capacitor - 3.3 $\mu$ F 50V	9-143
1604 1381	Capacitor - 4.7 $\mu$ F 50V	9-144
1604 1382	Capacitor - 10 $\mu$ F 50V	9-145
1604 1383	Capacitor - 22 $\mu$ F 50V	9-146
1604 1386	Capacitor - 100MF 50V	9-147
1604 1390	Capacitor - 1000MF 50V	9-148
1605 0141	Capacitor - 4700PF 50V	9-149
1606 0658	Capacitor - 0.1 $\mu$ F 50V	9-150
<b>1606 1308</b>	Capacitor - 27PF 50V	9-151
1606 1326	Capacitor- 100PF 50V $\pm$ 10%	9-152
1606 1348	Capacitor - 0.022 $\mu$ F 50V	9-153
1606 1451	Capacitor - 0.1 $\mu$ F 50V	9-154
1606 1452	Capacitor - 0.01 $\mu$ F 50V	9-155
1610 0035	Resistor - 100OHM 1/8W $\pm$ 5%	9-156
1610 0047	Resistor - 330OHM 1/8W $\pm$ 5%	9-157
1610 0053	Resistor - 1KOHM 1/8W $\pm$ 5%	9-158
1610 0057	Resistor - 1.5KOHM 1/8W $\pm$ 5%	9-159
1610 0065	Resistor - 3.3KOHM 1/8W $\pm$ 5%	9-160
1610 0067	Resistor - 4.7KOHM 1/8W $\pm$ 5%	9-161
1610 0071	Resistor - 10KOHM $\pm$ 5%	9-162
1610 0073	Resistor - 12KOHM 1/8W $\pm$ 5%	9-163
1610 0079	Resistor - 22KOHM 1/8W $\pm$ 5%	9-164
1610 0107	Resistor - 1MOHM 1/8W $\pm$ 5%	9-165
1610 0286	Capaciter - 100PF 50V $\pm$ 10%	9-166
1611 4103	Resistor - 10KOHM 1/4T $\pm$ 5%	9-167
1611 4229	Resistor - 2.2OHM 1/4W $\pm$ 5%	9-168
1611 4272	Resistor - 2.7KOHM 1/4T $\pm$ 5%	9-169
1611 4393	Resistor - 39KOHM 1/4T $\pm$ 5%	9-170
1611 4472	Resistor - 4.7KOHM 1/4W $\pm$ 5%	9-171
1611 4563	Resistor - 56KOHM 1/4T $\pm$ 5%	9-172